



***RoadRunnerSite.com***

## **RESTORATION TIPS SERIES**

# **Air Grabber Diagrams**

**Under the Hood and Dash Switch Info**



**MOPAR B-Body  
Restoration Q&A**

## 1970 Road Runner Air Grabber Switch Location

Here are the measurements for the location of the switch for the air grabber hood controls on a 1970 Plymouth Road Runner.

The switch is located just to the right and below the steering column. Directly above on the panel are the wiper control switches.

The piece on the left edge of the photo is the panel to the right bottom of the steering column.

The ash tray is not shown, but the measurement of 6 1/8 inches is from the right side of the air grabber switch panel to the edge of the dash where the ash tray starts.

As far as I can see on my 1970 Road Runner, the hole in the dash for the switch is the size of the hole in the switch panel.

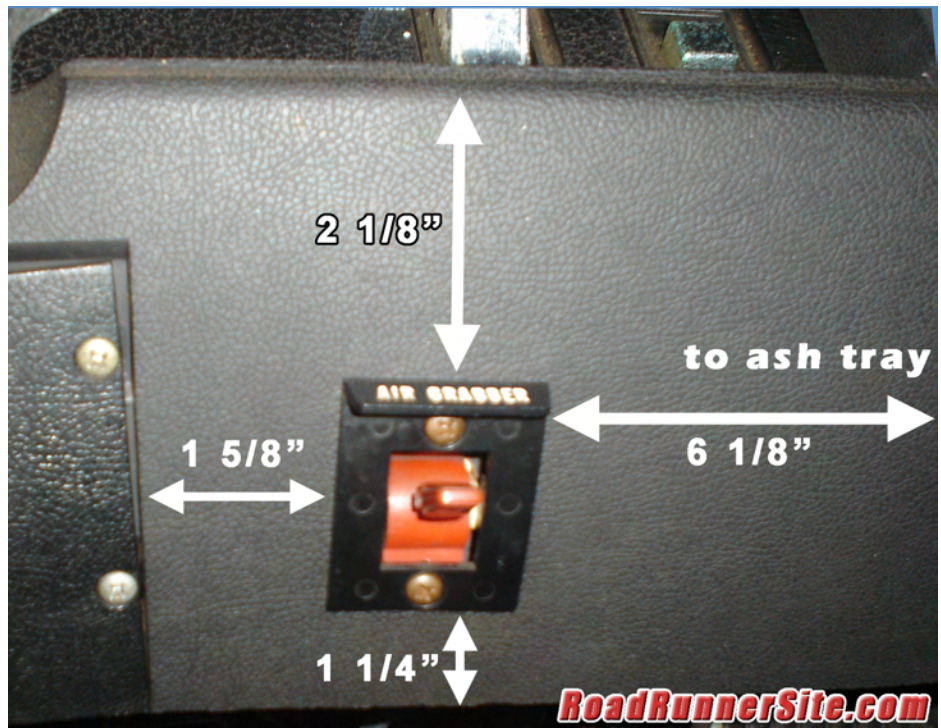

All measurements are in inches.

*Note: Do not cut your hole to the measurements shown in the image. The measurements are to locate the switch plate. The two sheet metal screws on the plate above and below the switch will need to attach the switch to the dash panel.*



**RoadRunnerSite.com**

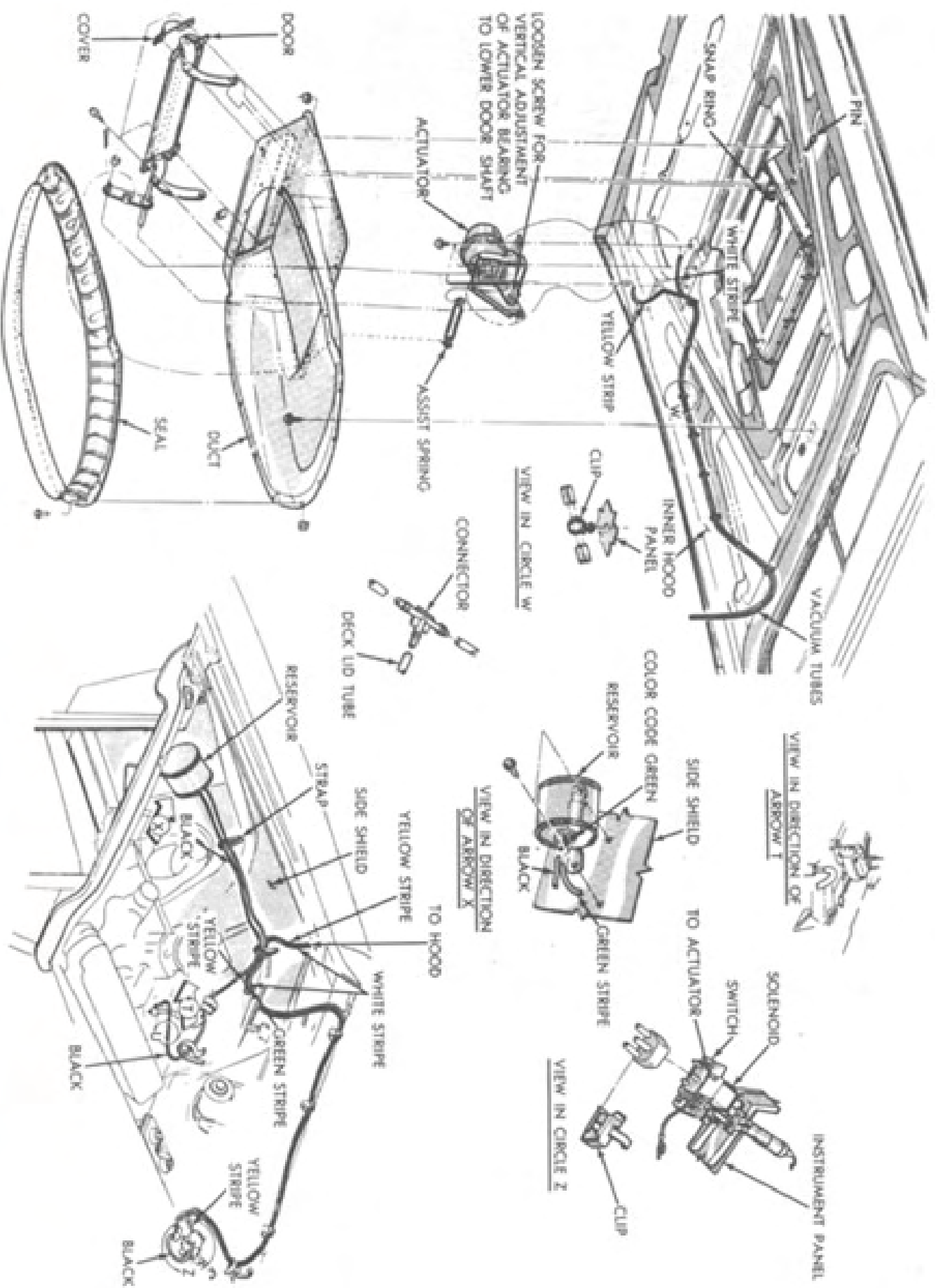

1970-71 Plymouth fresh air hood. Also 1971 Charger.

